

South 3 The Saltings

Rate Band F ~ Sunday Arrival
2 Bedrooms ~ Beds on Landing ~ Sleeps 6
2 Double Beds ~ 2 Single Beds ~ Linen & Towel Service
Cot & High Chair ~ Dogs Welcome
STB Grading ~ 1 Star

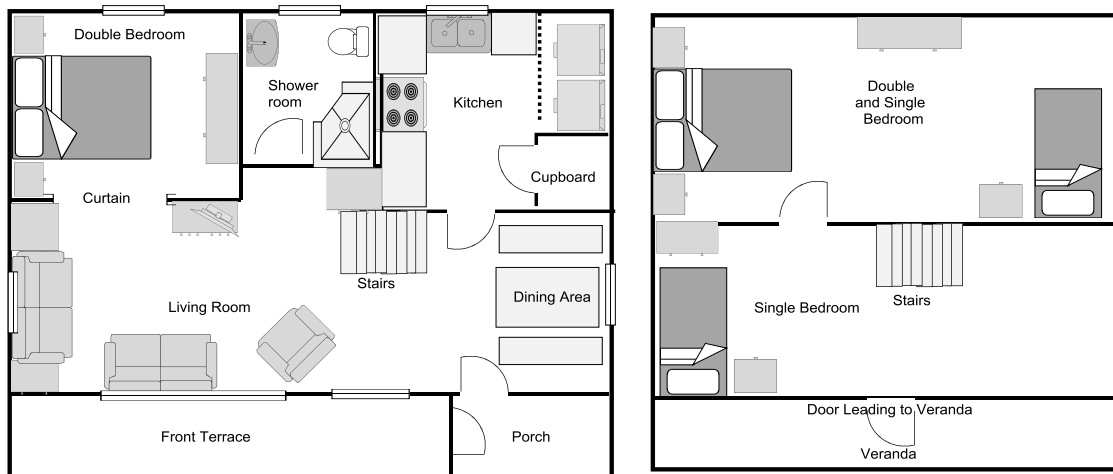

Plan of The Saltings (not to scale)



The Saltings is set in the beautiful village of Kilchoan, a perfect base for exploring the surrounding area and is within easy walking distance of the shop, ferry and pub. With an unusual wooden interior and comfortable furnishings, the cottage is cosy at night and fresh, bright and homely during the day. The terrace at the front and veranda upstairs allow you to enjoy outstanding views of the sea, islands and hills around. The garden, which has a picnic bench and is fenced off, makes it ideal for young children.

Ground floor: hall with cloakroom leading to open plan living / dining area with separate kitchen and bathroom. Bedroom with double bed, curtained off from the living room.
Upstairs: bedroom with double bed and single bed, single bed on an open landing with balcony.

Facilities:

Kitchen: Freezer, Fridge, Microwave, Electric Oven, Washing Machine, Tumble Drier.

Bathroom: Family bathroom with large shower enclosure and electric shower.

Heating: Storage Heaters and Electric Heaters.

TV & Audio: TV, DVD, CD, Radio Tape Cassette Player

Enclosed Garden: Picnic Table with Seats, Garden Furniture.

The door will be unlocked for your arrival and the **key** will be on the dining table.

Most **mobile** reception is good in Kilchoan; a phone box is opposite the church.

The normal day of arrival is a **Sunday** and the property is available from **4.00pm** on the holiday start date until **10.00am** on the finish date.

Please read the **meters** on arrival and departure: the costs per unit will be clearly displayed in the house. The hot water, heating (if necessary) and refrigerator will be on for your arrival. Leave a cheque or cash in payment for the electricity to Mr. B. Hunt.

There is a **Linen & Towel Service** available for this house. Please contact Steading Holidays for further details. In addition, tea towels, kitchen hand towel and bathmats will be provided, but there is no bedding supplied with the cot. If you wish to bring your own linen, the double beds have double duvets.

Dogs are welcome, but we ask owners to comply with the following: dogs to be kept under strict control at all times; not allowed in the bedrooms or on soft furnishings and not left unattended in the house. All dog faeces to be removed from the garden and immediate surrounding areas.

You are respectfully reminded that any damages must be reported and paid for and properties **must** be left in a clean and tidy condition prior to departure.

We do not normally call on you during your stay here as we have found from past experience that timing for this can tend to be difficult, any problems phone your House Manager Bill Lloyd, on 07818 240 080 or call the Steading Holidays office.

Steading Holidays ~ www.steading.co.uk ~ Tel. No: 01972 510 262